

STATUS: D

NOTES:-

- ALL DIMENSIONS ARE IN MILLIMETERS. LEVELS ARE IN METERS UNLESS OTHERWISE MENTIONED.
- WRITTEN DIMENSIONS ARE TO BE FOLLOWED. DRAWINGS ARE NOT TO BE SCALED.
- ANY DISCREPANCY IN THE DRAWING SHALL BE BROUGHT TO THE NOTICE OF THE ARCHITECT/S.
- THIS DRAWING SHALL BE READ IN CONJUNCTION WITH OTHER RELEVANT DRAWINGS.
- CEMENT CONCRETE SHALL BE M-25 GRADE FOR R.C.C. WORKS.
- ALL BRICK WORK SHALL BE IN CEMENT MORTAR GRADE M1(1:5).
- ALL WALLS SHALL BE PLASTERED IN CEMENT MORTAR 15mm Thk. (1:5) IN TWO COATS EXTERNALLY & 12mm THICK (1:6) INTERNALLY AND CEILING SURFACES SHALL BE PLASTERED IN CEMENT MORTAR 6mm Thk. IN (1:5) WITH FINISHED. IN CEMENT PAINT AND WHITE WASH RESPECTIVELY.
- DOOR : GOOD QUALITY TEAK WOOD FRAMES WITH WATER RESISTANT & FLUSH PANEL WITH GOOD WOODEN QUALITY. WINDOWS : GOOD QUALITY TEAK WOOD FRAME & SHUTTER WITH FIXED GLASS OF 5 mm THK. M.S SAFETY GRILL :-PROVIDING AND FIXING M.S. GRILLS OF REQUIRED PATTERN IN FRAMES OF WINDOWS/OPENINGS ETC.,WITH M.S. FLATS, SQUARE OR ROUND BARS ETC., COMPLETE.
- FINISHING & FLOORING :- AS/SCHEDULE - (1)
- SURFACE BELOW LEAN CONCRETE SHALL BE WELL COMPACTED.
- LAYING BRICK BAT COBA USING HALF BRICK WITH CEMENT MORTAR 1:5(1 CEMENT: 5 COARSE SAND) ADMIXED WITH PROPRIETARY WATER PROOFING COMPOUND CONFORMING TO IS:2645 TO REQUIRED SLOPE TREATING THE PARAPET WALL UP TO 300mm HEIGHT WITH APP MEMBRANE INCLUDING REVERSE ROUNDING(GULTA) OF JUNCTIONS OF WALL AND SLABS WITH MORTAR OF RATIO 1:4 ADMIXED WITH WATER PROOFING COMPOUND
- THE SIZE OF BRICK 250x125x75mm Thk. WITH BRICK STRENGTH OF 10N/mm<sup>2</sup>.
- BIFLEX TO SHALL BE USED FOR PRECONSTRUCTION ANTI-TERMITE TREATMENT AS/CPWD SPECIFICATION.

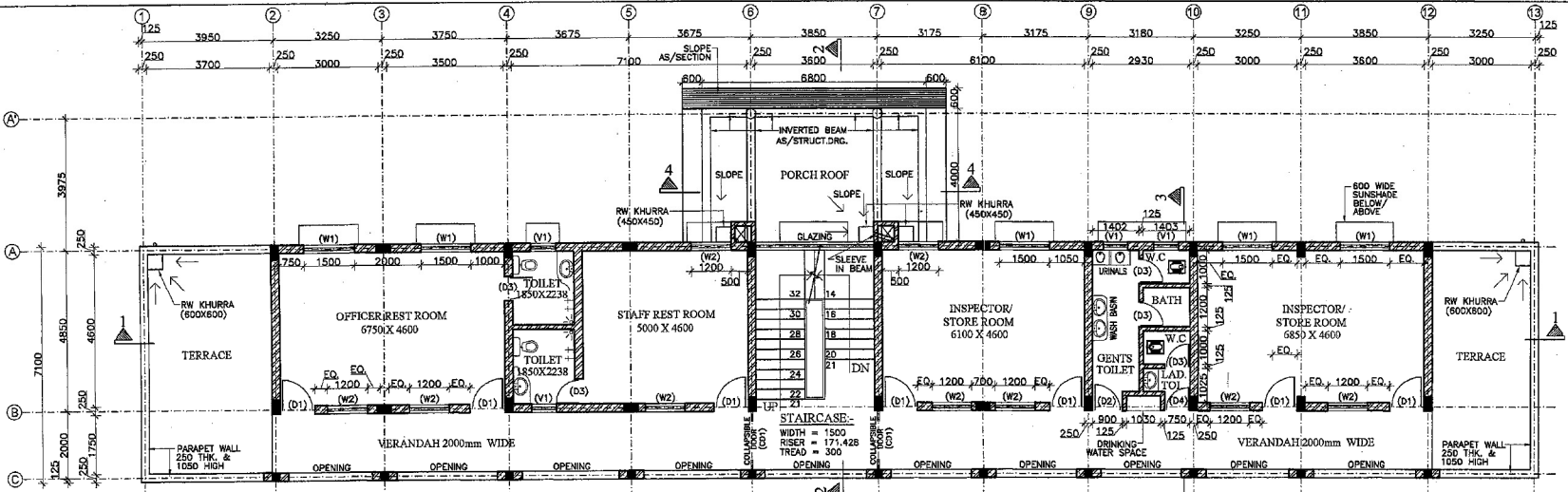

FIRST FLOOR PLAN  
FIRST FLOOR COVERED AREA : - 249.06 Sq.m.

LEVELS SCHEDULE FOR STATION BUILDINGS

S.N.	STATION BUILDING WITH LOCATION	ORIGINAL GROUND LEVEL (O.G.L)	RAIL TOP LEVEL UP DN	PROPOSED PLINTH LEVEL
1.	KARWANDYA STATION BUILDING	107.464	109.260 109.759	109.759
2.	KUDRA STATION BUILDING	85.969	88.149 88.145	88.149
3.	DURGAWATI STATION BUILDING	71.409	73.736 73.826	73.826

\* THE LEVEL SHALL BE VERIFIED AT SITE BEFORE FIXING OF PLINTH LEVEL

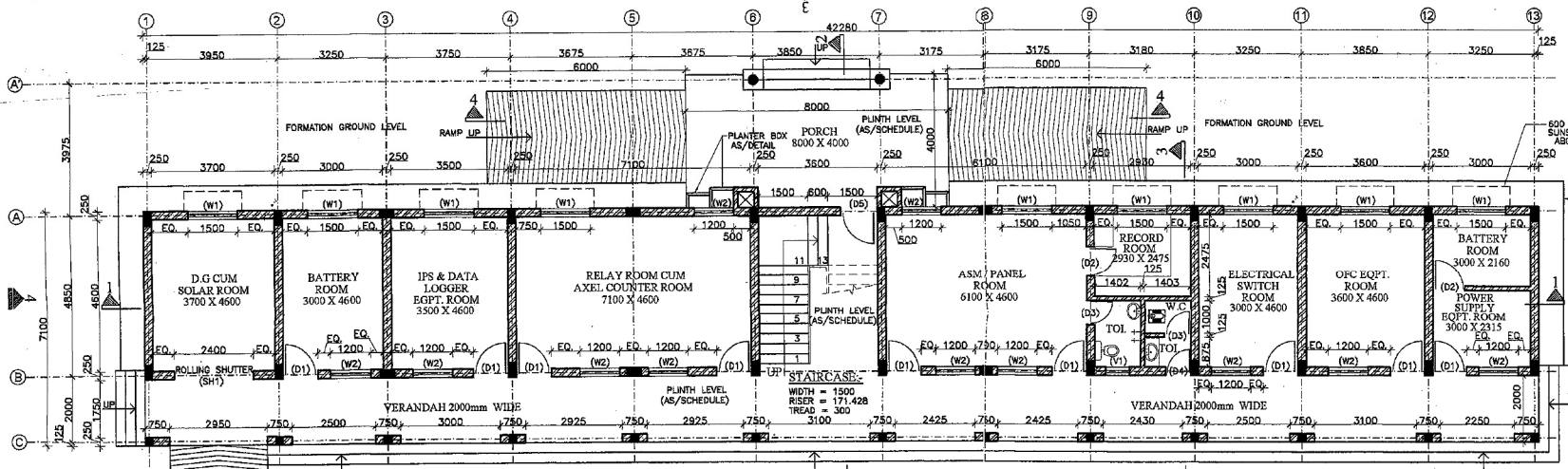

GROUND FLOOR PLAN  
GROUND FLOOR COVERED AREA : - 300.18 Sq.m.

- REFERENCE DRAWINGS:-
- AA/RLY/C&C/DFC-EC/SB/AR-01 (SHEET 2 OF 3 & 3 OF 3)
  - AA/RLY/C&C/DFC-EC/SB/AR-02
  - AA/RLY/C&C/DFC-EC/SB/EL-01
  - AA/RLY/C&C/DFC-EC/SB/PL-04 (SHEET 1 OF 3 TO 3 OF 3)

FINISHING SCHEDULE (1)

S.N.	LOCATION	FLOORING	DADO/SKIRTING
1.	ROOMS/ COV. VERANDAH	MARBLE MOSAIC CAST IN SITU/ PRECAST TERRAZZO TILES FLOORING.	SAME FINISHING AS FLOORING HEIGHT 100mm.
2.	BATTERY ROOM	ACID AND ALKALI RESIST TILES	ACID AND ALKALI RESIST TILES UPTO 1500mm HEIGHT
3.	TOILET	CERAMIC TILES	SAME FINISHING AS FLOORING HEIGHT 2100mm.
4.	BATH	CERAMIC TILES	SAME FINISHING AS FLOORING HEIGHT 2100mm.
5.	W.C	CERAMIC TILES	SAME FINISHING AS FLOORING HEIGHT 800mm.
6.	STAIRCASE	KOTA STONE FLOORING	100 MM HIGH KOTA STONE SKIRTING.
7.	FINISHING INTERNAL	ALL WALLS & CEILING TO BE TREATED WITH 2MM THICK POP FOLLOWED WITH A COAT OF ACRYLIC / OIL BOND DISTEMPER EXCEPT STAIRCASE.	
8.	FINISHING EXTERNAL	ACRYLIC SMOOTH EXTERIOR FINISH ON PLAIN PLASTERED WALLS.	

DESIGNED BY Padma Reddy	DRAWN BY M.Gautham	CHECKED BY PBR	REVIEWED BY PVS	APPROVED BY [Signature]	SCALE: AS SHOWN	DATE: 19/07/2012	CONTRACTOR: BSC - C&C JV Plot No. 70, Institutional District-03, Gurgaon-122001	PROJECT NO: AA/RY/C&C/DFC-EC/SB/AR-01
REVISION NO. DATE DESCRIPTION REV-2 26-JUNE-2012 REVISED AS/SMC COMMENTS REV-1 14-JUNE-2012 REVISED AS/SMC COMMENTS REV-0 26-MAY-2012 SUBMITTED FOR APPROVAL		APPROVED BY [Signature] G.M(DFCC)		APPROVED BY [Signature] DPM(MGS)		APPROVED BY [Signature] PMC		APPROVED BY [Signature] BSC - C&C JV
संशोधन Rev - 2		Approved with remarks vide letter of 19.7.12.		Dedicated Freight Corridor Corporation of India Ltd. (A Govt. of India Enterprise), Ministry of Railway, 6th Floor, Pragati Maidan, Metro Station Building Complex, New Delhi		arvee associates architects engineers & consultants pvt. ltd Rauna Residential, Gurgaon Colony, Haryana-122002, India Tel: +91-4062372766, Fax: +91-40-23726277 Email: arvee@arveerates.com, Web: www.arveerates.com		PROJECT NO: AA/RY/C&C/DFC-EC/SB/AR-01 SHEET NO. OF 03 TITLE: GROUND FLOOR & FIRST FLOOR PLAN FOR PROPOSED STATION BUILDING STATUS: D