

SECTIONAL ELEVATION OF OBLIGATORY & VIADUCT SPANS

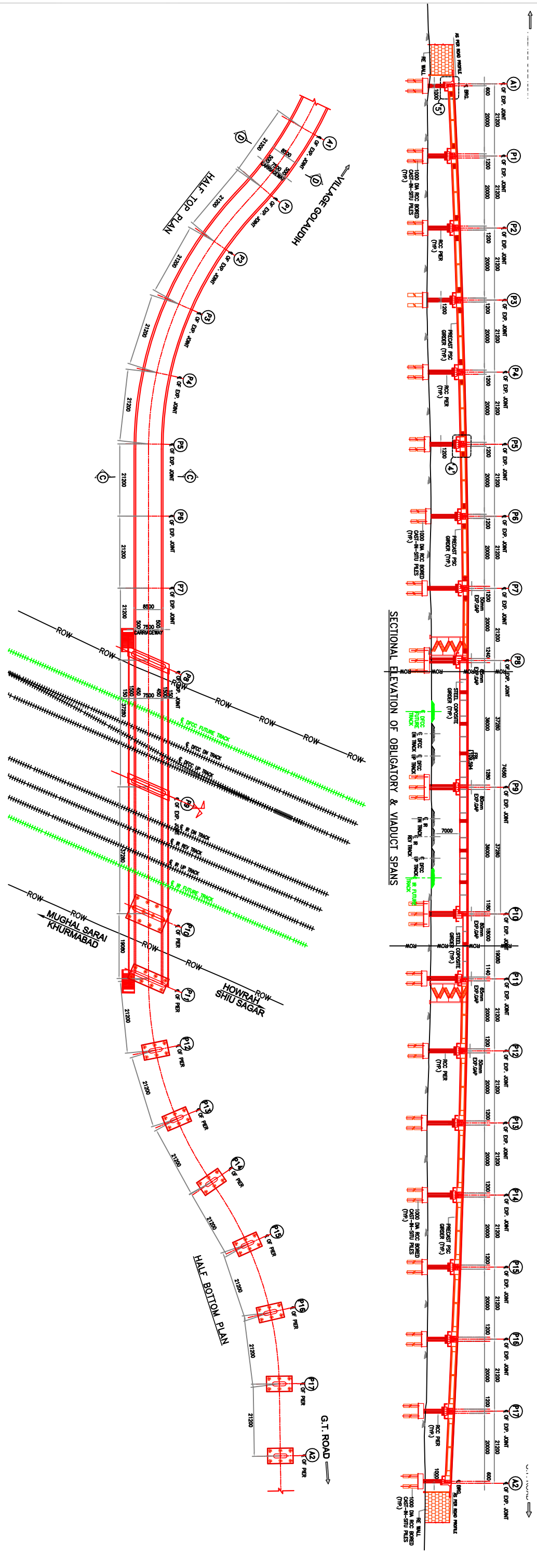

| VERTICAL PROFILE | GROUND LEVEL (m) | RAIL. (m) | HORIZONTAL PROFILE |
|------------------|------------------|-----------|-------------------------|
| Station P1 | 96.790 | 96.790 | STRAIGHT LENGTH 40.000m |
| Station P2 | 96.670 | 96.670 | CURVED LENGTH 50.000m |
| Station P3 | 96.630 | 96.630 | CURVED LENGTH 50.000m |
| Station P4 | 96.600 | 96.600 | CURVED LENGTH 50.000m |
| Station P5 | 96.599 | 96.599 | CURVED LENGTH 50.000m |
| Station P6 | 96.598 | 96.598 | CURVED LENGTH 50.000m |
| Station P7 | 96.597 | 96.597 | CURVED LENGTH 50.000m |
| Station P8 | 96.596 | 96.596 | CURVED LENGTH 50.000m |
| Station P9 | 96.595 | 96.595 | CURVED LENGTH 50.000m |
| Station P10 | 96.594 | 96.594 | CURVED LENGTH 50.000m |
| Station P11 | 96.593 | 96.593 | CURVED LENGTH 50.000m |
| Station P12 | 96.592 | 96.592 | CURVED LENGTH 50.000m |
| Station P13 | 96.591 | 96.591 | CURVED LENGTH 50.000m |
| Station P14 | 96.590 | 96.590 | CURVED LENGTH 50.000m |
| Station P15 | 96.589 | 96.589 | CURVED LENGTH 50.000m |
| Station P16 | 96.588 | 96.588 | CURVED LENGTH 50.000m |
| Station P17 | 96.587 | 96.587 | CURVED LENGTH 50.000m |

LONGITUDINAL ELEVATION INCLUDING FILLED UP PORTION

DETAIL - '4'

P1 TO P7 & P12 TO P17

SCALE 1:75

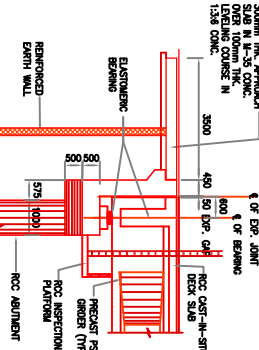
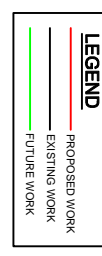

DETAIL - '5'

(AT P1 & A2)

SCALE 1:75

TYPICAL PLAN OF PILE GROUP

(AT VIADUCT SPAN)

SCALE 1:100

ABUTMENT CAP PLAN A1 & A2

SCALE 1:75

TYPICAL PIER CAP PLAN

P1 TO P7 & P12 TO P17

SCALE 1:75

SECTION D-D

SCALE 1:100

SECTION C-C

SCALE 1:100

| | | | |
|--|---|--|---|
| DESIGNER'S NAME DR. S. S. CHAKRAVARTY | DESIGNER'S SIGNATURE | DESIGNER'S DESIGNATION SR. CIVIL ENGINEER | DESIGNER'S OFFICE ADDRESS MGS DIVISION |
| CHECKED BY DR. S. S. CHAKRAVARTY | CHECKED SIGNATURE | CHECKED DESIGNATION SR. CIVIL ENGINEER | CHECKED OFFICE ADDRESS MGS DIVISION |
| APPROVED BY DR. S. S. CHAKRAVARTY | APPROVED SIGNATURE | APPROVED DESIGNATION SR. CIVIL ENGINEER | APPROVED OFFICE ADDRESS MGS DIVISION |
| DATE 24/07/2018 | DATE | DRG. NO. PFC/FC/ROB/LSZ/GAD/01 (Sheet 2 of 2) | REV. R0 |
| PROJECT DEDICATED FREIGHT CORRIDOR CORPORATION OF INDIA LIMITED (A GOVERNMENT OF INDIA ENTERPRISE) | PRODUCT PROPOSED 2-LANE ROB BETWEEN KHURMABAD SHU SAGAR STATION AT KM 58+477.19 AND ROAD KM VILLAGE GOLLAUDH AND NH2 ON MUGHALSARAI - GAYA SECTION IN L&L OF LC 52 | | |
| TITLE GENERAL ARRANGEMENT DRAWING | CONSULTANTS PARK PROJECTS CONSULTANCY PVT. LTD. NEW DELHI | | |