

Note

Sub:-RTI of Shri Manish V Patel Mograwadi Near Railway station valsad Near Ramesh Guest House Mograwadi, -RTI-246

Ref:- Western Railway on 04/04/2025 with reference number: WRAIL/R/E/25/00463

The detailed remarks are tabulated below:-

Sl No	Remarks in RTI	Reply
1	<p>1. Railway Safety Norms & Approvals</p> <p>a. Provide certified copies of Railway Board or Ministry of Railways guidelines specifying the minimum required distance between railway tracks and residential properties.</p> <p>b. Clarify whether DFCCIL obtained the legally required No Objection Certificate (NOC) for constructing the track within 30 metres of residential areas. If yes, provide a copy of the NOC issued.</p> <p>c. Provide details of any expectations or exemptions granted in cases where the railway track is constructed within 30 metres of residences.</p> <p>d. Share copies of any environmental impact assessments (EIA) or safety audits conducted before approving this project.</p>	<p>As per Railway circular No.W419.L.NOC(GEN)III 28.05.2014 minimum clearance of 3.00m between Railway boundary and nearest edge of building shall be ensured. This circular can be collected from DFCCIL office, ENGINEERS BUILDING, 1st Floor, Pramuk darshan 4, near Dmart, valsad to Atul road ,pin 396007-Valsad, Gujarat.</p> <p>In case of Shri Manish V Patel Mograwadi Near Railway station valsad Near Ramesh Guest House Mograwadi the distance between Railway/DFC boundary and fencing of house is 5.9m and edge of house is 7.55m. The house of Shri Manish V Patel is at a distance of 12.55 m from DFC UP line and concrete boundary wall has been constructed at Railway/DFC boundary to ensure safety.</p> <p>As new house has not been constructed within 30m of railway boundary by the resident and the house exists before laying DFC track, NOC is not required.</p> <p>There is no impact to Environment at this location due to construction of DFCCIL track</p>
2	<p>Site Inspection & Safety Compliance.</p> <p>a. Has Western railway or DFCCIL conducted a safety survey of this residential area to assess the risks posed by railway operations? If yes, Provide a copy of the report.</p>	<p>This house was inspected by DFC officials Executive Engg/BL and Jr.Executive Engg/BL on 07.04.2025 and confirmed that no risk is involved to near by residential area due to train operations .</p>

	<ul style="list-style-type: none"> b. List the precautionary and mitigation measures taken to prevent damage to houses near the railway track. c. Provide documents showing any compensation or rehabilitation plan for residents affected by the project. d. Name the officials responsible for approving and monitoring this project compliance with safety norms. 	<p>In this location concrete Boundary wall has been constructed at Railway/DFC boundary by DFCCIL to ensure safety.</p> <p>Compensation shall be paid as per Land acquisition act of Railway to the land losers and PAPs. As the house is at a distance of 12.55m from DFC UP track and no damage has been occurred due to movement of train on DFC track, compensation of the house is not permitted on Safety ground. As DFC has laid track on DFC/Railway land, no compensation is allowed.</p> <p>The safety norms of this project have been approved and monitored by competent Authority of DFCCIL/Railways.</p>
3	<p>Structural Damage & Compensation.</p> <ul style="list-style-type: none"> a. Has DFCCIL or western Railway received complaints from residents regarding structural damage due to train vibrations and construction activity? If yes, Provide copies of all complaints along with responses issued. b. Provide documents or records related to any survey conducted to assess structural damage in the affected area. c. Mention Whether any compensation has been provided to affected residents. If so, provide details of the amount and beneficiaries. d. What is the official process for residents to claim compensation for damages cause by railway operations? Provide guidelines and application formats. 	<p>No complaints from residents regarding structural damage due to train vibrations and construction activity has been received except Shri Manish V Patel Mograwadi Near Railway station valsad Near Ramesh Guest House Mograwadi for which safety inspection was carried out by DFC officials Executive Engg/BL and Jr.Executive Engg/BL on 07.04.2025</p> <p>Immediate safety inspection carried out by DFC officials i.e Executive Engg/BL and Jr.Executive Engg/BL on 07.04.2025. The report of same is enclosed here with.</p> <p>As the house of Shri Manish V Patel Mograwadi Near Railway station valsad Near Ramesh Guest House Mograwadi is at a distance of 12.55m from DFC UP track and no damage has been occurred due to movement of train on DFC track hence compensation of the house is not permitted on Safety ground.</p> <p>If DFC has laid track on DFC/Railway land, no compensation shall be allowed.</p>
4	<p>4. Accountability and corruption inquiry.</p> <ul style="list-style-type: none"> a. Provide the names, designations, and contact details of the officials responsible for 	<p>The clearance for DFCCIL track construction is given by competent Authority of DFCCIL/Railways.</p>

	<p>granting clearance for DFCCIL track construction near my residential area.</p> <p>b. Have any corruption complaints or inquiries been filed against DFCCIL officials related to land acquisition, construction or safety violations? If yes, Provide details.</p> <p>c. Who conducted the last independent audit of DFCCIL operations in this region, and what were the findings? Provide the report.</p>	<p>No corruptions complaints or enquiries filed against DFCCIL officials related to land acquisition, construction or safety violations</p> <p>Necessary Audit has been carried out as per operation manual of DFCCIL.</p>
5	<p>Legal Compliance & Action Taken</p> <p>a. Provide copies of any legal notices, court cases, or directives related to violations of safety norms in this DFCCIL project.</p> <p>b. What actions have been taken against DFCCIL OR railway officials for falling to comply with safety norms?</p> <p>c. Provide a list of penalties imposed on DFCCIL or railway contractors for non-compliance with safety and structural guideline.</p>	<p>There is no case of legal notices, court cases, or directives related to violations of safety norms in this DFCCIL project.</p> <p>There are no case of violation of safety norms for which action has to be taken against DFCCIL or Railway officials.</p> <p>There is no case of non-compliance with safety and structural guideline on DFCCIL/Railway contractor's for which Penalties has been imposed</p>

RAHUL CHOWDHURY
Digitally signed by RAHUL CHOWDHURY
Date: 2025.04.29 16:07:02 +05'30'

Executive Engg/BL

Dy.PM/Engg/BL

Please find the attached reply of RTI-246 for further process & approval

Dy.CPM/Engg/BL

For further process
23/4/25

Dy.PM/Engg/BL
29/04/25

APIO/mum/N

Note

Sub:-Grievances of Shri Manish V Patel Mograwadi Near Railway station valsad Near Ramesh Guest House Mograwadi, -registration number : MORLY/E/2025/0007493

Ref:- Grievances of Shri Manish V Patel registration number : MORLY/E/2025/0007493 dated 07.03.2025

With reference to above, I,Executive/Engg/BL along with Jr.Executive Engg/BL have visited the house of Shri Manish V Patel Mograwadi Near Railway station valsad Near Ramesh Guest House Mograwadi. Following observations has been made in this regards:-

1. House has been inspected and following dimensions has been noted:-

Sl No	Item	Distance
1	Distance of Boundary wall of house from DFC UP track	10.9m
2	Distance of Edge of house from DFC UP track	12.55m
3	Distance of Boundary wall of house from DFC/Railway boundary	5.90 m
4	Distance of Edge of house from DFC/Railway boundary	7.55 m

The house is at distance of 12.55 m from DFC UP track and 7.55m from DFC/Railway boundary, hence safe.

2. This house was inspected by DFC officials Executive Engg/BL and Jr.Executive Engg/BL and confirmed that no vibration observed at this house due to train movement and no such structural damage has occurred in this house due to train movement.
3. In this location concrete Boundary wall has been constructed at Railway/DFC boundary by DFCCIL to ensure safety.As new house has not been constructed with in 30m of railway boundary and the house exists before laying DFC track, NOC not required.
4. Immediate safety inspection carried out by DFC officials i.e Executive Engg/BL and Jr.Executive Engg/BL.
5. As the house is at a distance of 12.5m from DFC UP track and no damage has been occurred due to movement of train on DFC track, compensation of the house is not permitted on safety ground.
6. As DFC has laid track on DFC/Railway land, no compensation is permitted .

The detailed remarks of the grievances of Shri Manish V Patel is tabulated below:-

Y.S.
Executive/BL
07/04/2025

Sl No	Item	Reply
1	I am filing this grievance regarding the critical safety hazard posed by the DFCCIL freight train track, which is only 3 meters away from my legally registered house. As per Railway Board guidelines, a minimum 30-meter distance is required between railway tracks and residential areas, yet this rule has been violated. No No-Objection Certificate (NOC) was issued, and no safety measures have been implemented.	<p>An inspection was carried out by Executive Engg/BL and Jr.Executive Engg/BL at this location and it was found that the house is a distance of 12.55 m from DFC UP line and 7.55 m distance from Railway Boundary. In the letter, the PAP has mentioned that the DFCCIL freight train is only 3 m away from his legally registered house is factually incorrect.</p> <p>As per Railway circular No.W419.L.NOC(GEN)III 28.05.2014 minimum clearance of 3.00m between Railway boundary and nearest edge of building shall be ensured. In this case the distance between Railway/DFC boundary and fencing of house is 5.9m and edge of house is 7.55m. In this location concrete Boundary wall has been constructed by DFCCIL at Railway/DFC boundary to ensure safety. As new house has not been constructed within 30m of railway boundary and the house exists before laying DFC track, NOC not required</p>
2	Due to continuous train movement and vibrations, my house and surrounding residential area have suffered severe structural damage, making it unsafe for habitation. Despite multiple complaints to DFCCIL officials and the local municipal corporation, no survey has been conducted, and no corrective action has been taken. Instead, authorities brought police forces to intimidate us, violating our rights and worsening our distress.	The house is at a distance of 12.55 m from DFC UP line and concrete boundary wall has been constructed at Railway boundary, hence no such vibrations observed during Train movement. This house was inspected by DFC officials Executive Engg/BL and Jr.Executive Engg/BL and confirmed that no vibration observed at this house due to train movement and no such structural damage has occurred in this house due to train movement.
3	<p>My Demands:</p> <p>Immediate safety inspection of the area to assess the risk to residents.</p> <p>Written clarification regarding the legality of residential proximity to the tracks.</p>	<p>Immediate safety inspection carried out by DFC officials i.e Executive Engg/BL and Jr.Executive Engg/BL.</p> <p>As the house is at a distance of 12.55m from DFC UP track and no damage has been occurred due to movement of train on DFC track, compensation of the house is</p>

Y. S.
Genl/G-3/BL
07/04/2025

	Full compensation for my damaged house and residential area due to DFCCIL's project and train operations.	not permitted on Safety ground. As DFC has laid track on DFC/Railway land, no compensation is allowed.
4	Strict action against harassment faced by residents when raising concerns.	DFC Officials i.e Executive/Engg/BL and Jr.Executive/Engg /BL has visited the house of Shri Manish V Patel and talked to him regarding his complain. No harassment has been done to the resident and inhabitant of the house.
5	If this issue is not addressed within 30 days, I will escalate it to the Railway Ministry, NHRC, and the High Court for legal intervention. I urge you to take urgent action to prevent further damage and ensure our safety.	Noted.

A sketch and photos showing exact distance between DFC track and house is enclosed here with at Annexure A for ready reference. Dy.PM/Engg/BL is requested to kindly take further necessary action forward the case.

Dy.PM/Engg/BL

Dy.CPM/Engg/BL

Executive Engg/BL
07/04/2025

The detailed remarks of the grievances of Shri Manish V Rathod is tabulated as above after carrying inspection of house by Executive Engg/BL on 07/04/2025. Dy.CPM/Engg/BL is requested to kindly take further necessary action

Dy.PM/Engg/BL
07/04/2025

Dy.CPM/Engg/BL

07/4/25

APIO/MMM-N

Annexure A

Date of Inspection :- 07.04.2025

Sub:- Inspection of house of Shri Manish V Patel
Ref :- MORLY/E/2025/0007493 dated 07.03.2025

Plan of House

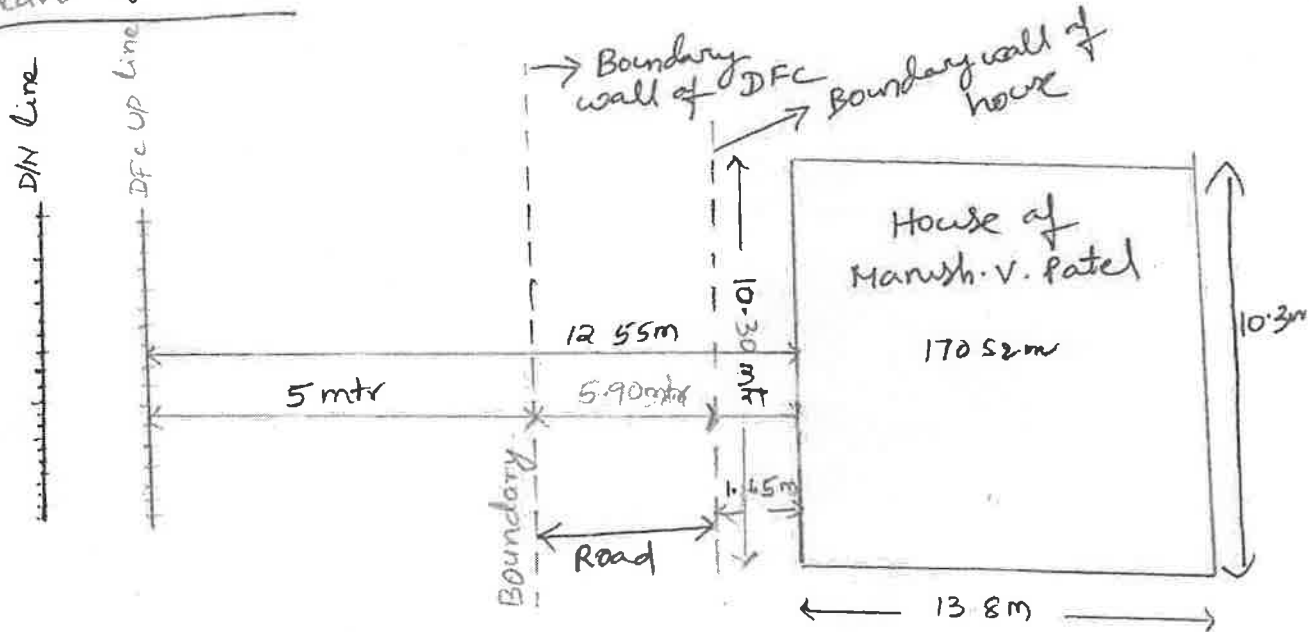

Elevation of House

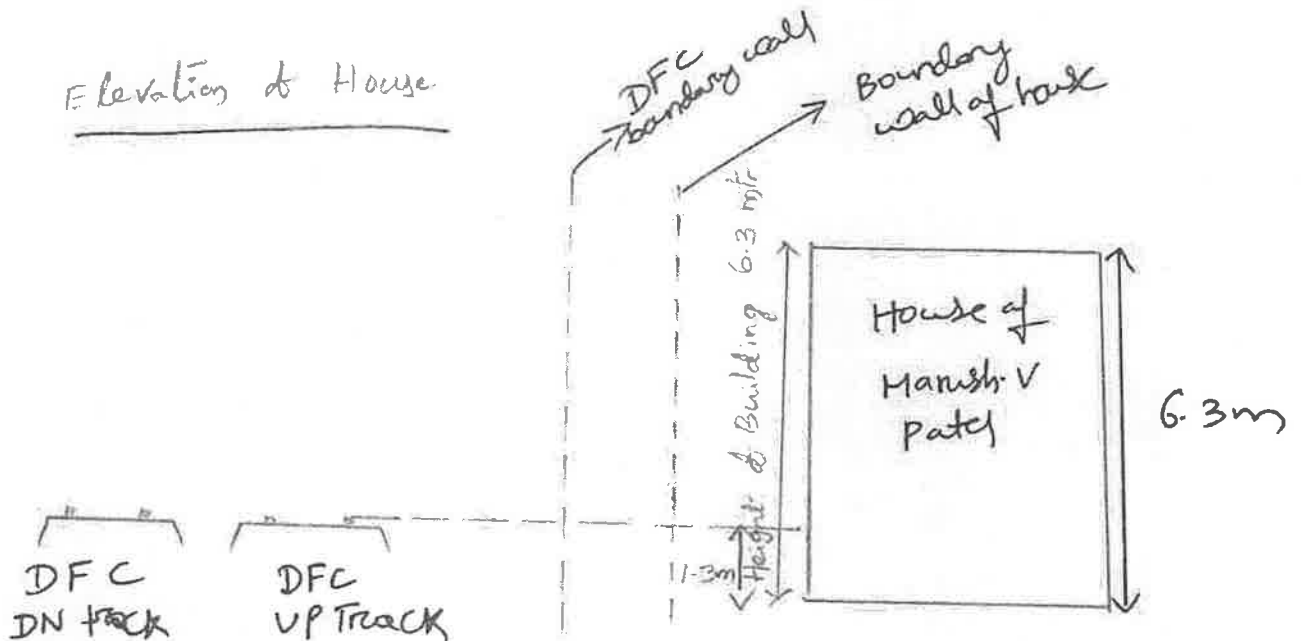

Height of building = 6.3 m

Height of building from top of DFC UP line
= 5 m

Height from ground level = 6.3 m = H

Clearance required = $H/2$ = 3.15 m

Clearance from Railway boundary = 7.55 m =

S. V. Kunte Rao
Sr. Civil Engineer
07.04.2025

Y. S. G. G. G.
07.04.2025