



डेडीकेटेड फ्रेट कोरीडोर

डेडीकेटेड फ्रेट कोरीडोर कॉर्पोरेशन ऑफ इंडिया लि.
भारत सरकार (रेल मंत्रालय) का उपक्रम
Dedicated Freight Corridor Corporation of India Ltd.
A Govt. of India (Ministry of Railway) Enterprise

MUMBAI NORTH
No :- MUM/N/RTI/ 407-I

Date 09/06/2025

JGM/ADMIN(CPIO)
DFCCIL, Noida

Sub: - Providing of Information under the provision of the RTI Act 2005. Case of
Shri Manish V. Patel, Mograwadi Near Railway Station Valsad Near
Ramesh Guest House, Mograwadi RTI - 340

Ref: - RTI Appeal No. DFCCIL/R/T/25/00022 dtd 15.05.2025

Vide above referred letters, the applicant has sought the information as stated in
column 1. (attached). The reply to be given regarding the information sought is being
attached.

Encl. 1. Reply duly approved by CGM/N/MUMBAI
2. Original Application seeking information

(Bratati Banerjee)
APM/HR
Mumbai, DFCCIL

35

Note

Sub:-RTI of Shri Manish V Patel Mograwadi Near Railway station valsad Near Ramesh Guest House Mograwadi -RTI-340

Ref:- Western Railway -Mumbai Division on 15.05.2025 with reference number:

DFCC/R/T/25/00022. *CPK 292-293*

The detailed remarks are tabulated below: -

| Sl No | Query in RTI | Reply |
|-------|--|---|
| 1 | Was any No Objection Certificate (NOC) or permission obtained from residents before DFCCIL Constructed freight tracks within 30 metres of houses in my area? If yes, Provide copies. | <p>The house of Shri Manish V Patel is at a distance of 12.55 m from DFC UP line and 7.55 m distance from Railway/DFCCIL Boundary. As new house or reconstruction of existing building has not been constructed within 30m of railway boundary by the resident and the house exists before laying DFC track, NOC is not required to be obtained by the party from Railway/Local authority. If he construct or reconstruct the building, the party has to apply for NOC</p> <p>As per circular No. 2007/LML/19/4 dated 16.05.2008(enclosed for your kind reference), " No new construction of any building or reconstruction of an existing building shall be allowed within a distance of half the height of the said building from the Railway track boundary, and in any case at least 3m away from such boundary. Further a 'No objection certificate' from the concerned Railways is required to be submitted by the party to the local authorities for granting permission for the building plans if proposed structure lies between the Railway boundary and the distance of 30m from it"</p> |
| 2 | Provide a copy of project plan and alignment approval for DFCCIL track laid 12.55 meters from my residence. | The approved project plan and alignment plan No. 12/AL/DG/1340/-CD REV-1 approved by Competent Authority on 22.01.2018 is enclosed here with |
| 3 | Share copies of any internal or third-party safety inspection or vibration impact reports conducted before or after construction of the said track. | A safety inspection was conducted by DFC officials Executive Engg/BL and Jr.Executive Engg/BL on 07.04.2025. The inspection report is enclosed here with. |

Y. S. Desai
Ex/Engg/BL

S. V. Desai
Jr. Exec/BL

| | | |
|---|---|---|
| 4 | Was any structural or environmental impact assessment done prior to construction near my house? If yes, provide full details. | Environmental And Social Impact Assessment Study (ESIA) For Western Corridor of Dedicated Freight Corridor Project (Phase 2) For JNPT-Vadodara and Rewari-Dadri Sections has been carried out. As this is voluminous document, it is requested to kindly visit DFCCIL Valsad office DFCCIL office, ENGINEERS BUILDING, 1st Floor, Pramuk darshan 4, near Dmart, valsad to Atul road ,pin 396007-Valsad, Gujarat to collect the document. |
| 5 | Provide names and designation of official involved in planning and executing DFCCIL track project in my area. | The planning and execution of DFCCIL track done after approval of same from competent Authority of DFCCIL/Railways. |
| 6 | Provide compensation policy applicable to residents whose properties suffered damage due to freight train operations. Was my property assessed for this? If yes, Share inspection or rejection reports. | Compensation shall be paid as per Land acquisition act of Railway to the land losers and PAPs. As the house of Shri Manish V Patel is at a distance of 12.55m from DFC UP track and no damage has been occurred due to movement of train on DFC track, compensation of the house is not permitted. As DFC has laid track on DFC/Railway land, no compensation is allowed. A safety inspection was conducted by DFC officials Executive Engg/BL and Jr.Executive Engg/BL on 07.04.2025 and confirmed that, the house of Shri Manish V Patel is at a distance of 12.55 m from DFC UP line track and no vibration observed at this house due to train movement and no structural damage has occurred in this house due to train movement. The inspection report is enclosed here with. |
| 7 | Was any public consultation or hearing with affected residents conducted? If yes, provide notice copies and minutes of meetings. | This information is not available in this office. All necessary statutory guidelines have been followed before construction and laying of DFCCIL track. |
| 8 | Why is my grievance continuously being transferred to DFCCIL despite it clearly being a case of safety rule violation and potential structural damage? | The grievances of Shri Manish V Patel were transferred to concerned department/Office of Railway. |
| 9 | Since DFCCIL is under the ministry of Railways, what action has Western Railway taken against illegal construction of track so close to | There is no illegal construction of DFCCIL track close to resident area. All the work has been carried out on DFCCIL/Railway land. All necessary approvals have been taken from competent authority of DFCCIL/Railway for construction of DFCCIL track. |

Y. S.
Genl/Engr/BL

du
Jr Engr/Genl/BL

37

| | | |
|----|--|--------------------------------------|
| | residential areas, and what authority allowed such development? | |
| 10 | What steps are being taken by Western Railway to ensure DFCCIL Complies with Railway Board norms across India? | No such documents available with us. |

DPM/Engg/BL is requested to kindly take further necessary action in this matter.

Executive/Engg/BL

Dy.PM/Engg/BL

Dy. CPM/Engg/BL is requested to forward for further approval



Dy. CPM/Engg/BL
07/06/2025

Dy.CPM/Engg/BL

PAWAN
KUMAR

Digitally signed by
PAWAN KUMAR
Date: 2025.06.07
14:23:26 +05'30'

APIO

May kindly approve after perusal per.

CCM/MUMBAT.

And 

Annexure A

Date of Inspection :- 07.04.2025

Sub:- Inspection of house of Shri Manish V Patel
Ref :- MORLY/E/2025/0007493 dated 07.03.2025

(297)

Plan of House

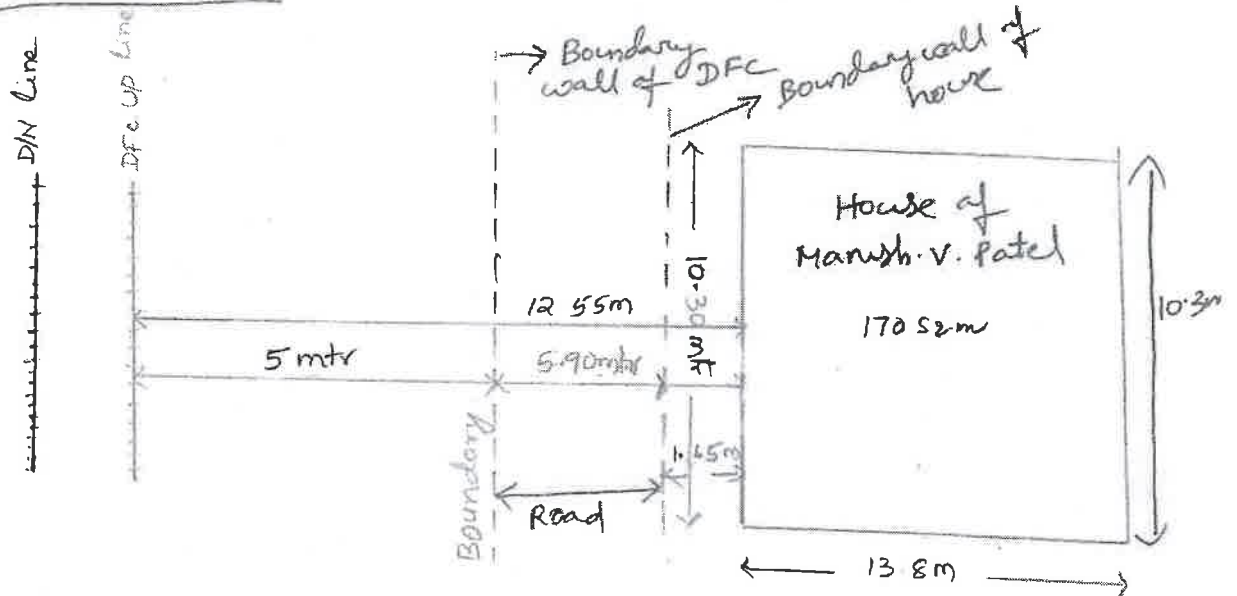

Elevation of House



Height of building = 6.3m
Height of building from top of DFC UP line = 5m
Height from ground level = 6.3m = H
Clearance required = $H/2 = 3.15m$
Clearance from Railway boundary = 7.55m =

Singhendra Rao
Sr. Engr. Civil/EL
07.04.2025

V. S. Rao
Sr. Engr. Civil/EL
07.04.2025

(10)

27/4

611

(296)

Government of India
Ministry of Railways
(Railway Board)

No.2007/LML/19/4

New Delhi Dated: 16.5.2008

General Manager (Engg),
Western Railway, Churchgate, Mumbai

✓ General Manager (Engg),
Central Railway
Mumbai.

Sub: Grant of 'No Objection Certificate' for construction of private buildings in private lands in vicinity of Railway Land in Mumbai Area.

(16)
CEG
Number of representations have been received by the Board due to denial of issue of 'No Objection Certificate' by the railways to construction of private buildings in private lands in vicinity of Railway Land in Mumbai area including some of the cases where the nearest track is at a considerable distance from the proposed building.

2. It is observed that extant rules on the subject in Mumbai area are governed by provisions in regulation No.29 (8) (ii) of the 'Govt. of Maharashtra, Urban Development Department Development Control Regulations for Greater Bombay-1991' which provides that "...no new construction of any building or reconstruction of an existing building shall be allowed within a distance of half the height of the said building from the Railway track boundary, and in any case at least 3m away from such boundary." Further a 'No objection Certificate' from the concerned railway is required to be submitted by the party to the local authorities for granting permission for the building plans if proposed structure lies between the railway boundary and the distance of 30 m from it.

3. Because the 'Railway Track Boundary' is not defined, problems are arising due to reckoning of horizontal clearance from railway boundary instead of 'Railway Track Boundary' as provided in the regulation No. 29(8)(ii) mentioned above.

4. Matter has been examined and it has been decided by the Board (ME) that for the purpose of regulation No.29 (8) (ii) of the 'Govt. of Maharashtra, Urban Development Department Development Control Regulations for Greater Bombay-1991' "Railway Track Boundary" be considered to be a horizontal distance of '6m plus height of railway embankment at the point of consideration' from the centre line of the railway track nearest to the proposed building or the actual railway land boundary from the centre line of the railway track nearest to the proposed building whichever is less.

28/4 (11) 5/2 6/2 295

4.1 The nearest track here will mean the existing track or the proposed track in future if contemplated to be constructed in the near future, nearest to the proposed building. While considering allowance for future track, the railway should not unduly keep such allowance for individual sites when future track is not feasible on that side in view of already existing buildings or structures on either side of the proposed site. Instructions issued under Railway Board letter No.94.LM(L)/14/22 dated 29.8.95 may also be referred to in this regard.

5. It is, therefore, advised that all such cases regarding issue of grant of 'No Objection Certificate' to construction of private buildings in private lands in vicinity of Railway Land in Mumbai area may kindly be dealt with accordingly. While granting 'NOC' railway may ensure that the provisions of para 827(b) of IRWM-2000 are complied with.

6. This is for your kind information and further necessary action. Fresh remarks in the cases earlier referred by Board to railways for comments, may be advised to the Board in view of above directions for further disposal of the same at this end.

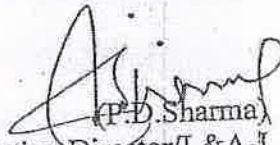
(P.D. Sharma)
Executive Director/L&A-I

16.5.08



RTI Details
RTI REQUEST DETAILS

293

| | | | |
|--|---|------------------------------|----------------------|
| Registration No. : | DFCCL/R/T/25/00022 | Date of Receipt : | 15/05/2025 |
| Transferred From : | Western Railway- Mumbai Division on 15/05/2025 With Reference Number : WRLMD/R/T/25/00242 | | |
| Remarks : | The matter not pertains to open libn eEngineering department | | |
| Type of Receipt : | Electronically Transferred from Other Public Authority | Language of Request : | English |
| Name : | MANISH VIJAYBHAI PATEL | Gender : | Male |
| Address : | Mograwadi Near Railway station, valsad Near Ramesh Guest House, Pin:396001 | | |
| State : | Gujarat | Country : | India |
| Phone No. : | +91-6353956749 | Mobile No. : | +91-6353956749 |
| Email : | xlines004manish@gmail.com | | |
| Status(Rural/Urban) : | Urban | Education Status : | Above Graduate |
| Letter No. : | Details not provided | Letter Date : | Details not provided |
| Is Requester Below Poverty Line ? : | No | Citizenship Status : | Indian |
| Amount Paid : | 0 (RTI fee is received by Western Railway (original recipient)) | Mode of Payment : | Payment Gateway |
| Does it concern the life or Liberty of a Person ? : | No(Normal) | Request Pertains to : | |
| Information Sought : | <p>As per the Right to Information Act 2005, I seek the following information regarding DFCCIL operations near my house:</p> <p>Was any No Objection Certificate (NOC) or permission obtained from residents before DFCCIL constructed freight tracks within 30 meters of houses in my area? If yes, provide copies.</p> <p>Provide a copy of project plan and alignment approval for DFCCIL track laid 12.55 meters from my residence.</p> <p>Share copies of any internal or third-party safety inspection or vibration impact reports conducted before or after construction of the said track.</p> <p>Was any structural or environmental impact assessment done prior to construction near my house? If yes, provide full details.</p> <p>Provide names and designations of officials involved in planning and executing DFCCIL track project in my area.</p> <p>Provide compensation policy applicable to residents whose properties suffered damage due to freight train operations. Was my property assessed for this? If yes, share inspection or rejection reports.</p> <p>Was any public consultation or hearing with affected residents conducted? If yes, provide notice copies and minutes of meetings.</p> | | |

Why is my grievance continuously being transferred to DFCCIL despite it clearly being a case of safety rule violation and potential structural damage?

Since DFCCIL is under the Ministry of Railways, what action has Western Railway taken against illegal construction of track so close to residential areas, and what authority allowed such development?

What steps are being taken by Western Railway to ensure DFCCIL complies with Railway Board norms across India?

I declare that I am an affected citizen and this information is requested in public and personal interest. Kindly send the reply within 30 days as per RTI Act 2005.

As per the Right to Information Act 2005, I seek the following information regarding DFCCIL operations near my house:

Was any No Objection Certificate (NOC) or permission obtained from residents before DFCCIL constructed freight tracks within 30 meters of houses in my area? If yes, provide copies.

Provide a copy of project plan and alignment approval for DFCCIL track laid 12.55 meters from my residence.

Share copies of any internal or third-party safety inspection or vibration impact reports conducted before or after construction of the said track.

Was any structural or environmental impact assessment done prior to construction near my house? If yes, provide full details.

Provide names and designations of officials involved in planning and executing DFCCIL track project in my area.

Original RTI Text : Provide compensation policy applicable to residents whose properties suffered damage due to freight train operations. Was my property assessed for this? If yes, share inspection or rejection reports.

Was any public consultation or hearing with affected residents conducted? If yes, provide notice copies and minutes of meetings.

Why is my grievance continuously being transferred to DFCCIL despite it clearly being a case of safety rule violation and potential structural damage?

Since DFCCIL is under the Ministry of Railways, what action has Western Railway taken against illegal construction of track so close to residential areas, and what authority allowed such development?

What steps are being taken by Western Railway to ensure DFCCIL complies with Railway Board norms across India?

I declare that I am an affected citizen and this information is requested in public and personal interest. Kindly send the reply within 30 days as per RTI Act 2005.

Print

Save

Close

Details for registration number : MORLY/E/2025/0007493

| | |
|--|---|
| Name Of Complainant | Manish V Patel |
| Date of Receipt | 07/03/2025 |
| Received By Ministry/Department | Railways, (Railway Board) |
| Grievance Description | |
| Railways, (Railway Board) >> Miscellaneous Railway Board/ Zone/ PSU/ PU/ Office : Western Railway - Mumbai I am filing this grievance regarding the critical safety hazard posed by the DFCCIL freight train track, which is only 3 meters away from my legally registered house. As per Railway Board guidelines, a minimum 30-meter distance is required between railway tracks and residential areas, yet this rule has been violated. No No-Objection Certificate (NOC) was issued, and no safety measures have been implemented. Due to continuous train movement and vibrations, my house and surrounding residential area have suffered severe structural damage, making it unsafe for habitation. Despite multiple complaints to DFCCIL officials and the local municipal corporation, no survey has been conducted, and no corrective action has been taken. Instead, authorities brought police forces to intimidate us, violating our rights and worsening our distress. My Demands: Immediate safety inspection of the area to assess the risk to residents. Written clarification regarding the legality of residential proximity to the tracks. Full compensation for my damaged house and residential area due to DFCCIL's project and train operations. Strict action against harassment faced by residents when raising concerns. If this issue is not addressed within 30 days, I will escalate it to the Railway Ministry, NHRC, and the High Court for legal intervention. I urge you to take urgent action to prevent further damage and ensure our safety. | |
| Current Status | Under process |
| Date of Action | 10/03/2025 |
| Officer Concerns To | |
| Officer Name | PG OFFICER (GENERAL MANAGER) |
| Organisation name | DFCCIL |
| Contact Address | DFCCIL 5TH FLOOR, SUPREME COURT METRO STATION BULDG, COMPLEX, NEW DELHI-110001 |
| Email Address | anilkumar1965@dfcc.co.in |
| Contact Number | 01123454990 |
| Reminder(s) / Clarification(s) | |
| Reminder Date | Remarks |
| 23/03/2025 | <p>Dear Sir/Madam,</p> <p>This is a serious reminder regarding my grievance about the DFCCIL freight train track being only 3 meters away from my legally registered house. If immediate action is not taken, there is a high risk of a train accident that could result in the loss of lives, including mine and those of my fellow residents.</p> <p>The continuous train movement and vibrations have already caused severe structural damage to our homes, making the area unsafe for habitation. Any further negligence could lead to a tragic disaster. I urge you to treat this as a matter of utmost urgency and take the necessary steps without further delay.</p> <p>Please act immediately to prevent a potential catastrophe. I look forward to your prompt response and action.</p> |

05/04/2025

290

This is my final and most urgent reminder regarding the extremely reckless and dangerous placement of the DFCCIL freight train track - a mere 3 meters from my legally registered residence. My previous complaint dated 23-03-2025 has been completely ignored, and this silence from your side amounts to gross negligence and willful disregard for human life.

The continuous vibrations from the freight trains are causing accelerated structural damage to our homes. Cracks are spreading, walls are shaking, and foundations are weakening. The entire locality is under physical and psychological stress. You are putting lives at immediate risk, including children, elderly, and working individuals who live here with the assumption that the government would protect, not endanger them.

Let me be absolutely direct: if any accident, injury, or death occurs due to this outrageous placement of the freight line, the blame will fall squarely on your department. There will be no excuse, and no protection from legal and public consequences. Every official who failed to act will be held personally accountable. This is not just an administrative lapse - it is a potentially criminal act of endangerment.

We are not going to wait quietly for disaster to strike. If this issue is not addressed immediately and decisively, I will escalate this matter through legal action, national media, human rights commissions, and public protests. You have been warned - this situation has crossed every line of acceptable delay and ignorance.

This is a matter of life and death. Take action now - or be prepared to face the full force of legal, civic, and public outrage.

289

WESTERN RAILWAY

जनसुचना अधिकारी
मंडल रेल प्रबंधक कार्यालय
मुंबई सेंट्रल, मुंबई
seniordennbct@gmail.com



Public Information Officer
Office of Divisional Railway Manager
Mumbai Central, Mumbai -400008.
Tel: 02267644401

File No: Engg/RTIA/ 237/24-25

dated 30.02.2025

To,

Shri Manish V. Patel,
Mogarwadi near Railway station,
Valsad near Ramesh Guest House,
Pin : 396001



Subject: - Supply of information under RTI Application by Shri Manish V. Patel, मुंबई सेंट्रल
Reference:-Registration Number WRI MD/R/E/25/00058 DTD 25/01/2025.

With reference to the above subject, it is to inform you that Engineering remarks are as under.

1. Minimum Distance Standards

a) As per Railway Board guidelines the minimum distance required between main railway tracks and residential area is more than 30 meters. If it is less than 30 meters than Railway NOC is required.

b) This guidelines is applicable all across the Indian Railways.

c) Copy of the Railway Board Circular No. 2015/LML-I/19/2 DTD 25/06/2015 is enclosed herewith

2. Implementation in specific area zone.

a,b&c) No survey has been carried out on the East side of Mograwadi area to find out the actual distance between main railway tracks and the nearest residential area.

If not satisfied with the reply you can approach Appellant authority & Additional Divisional Railway Manager ADRM (OP&HR) Western Railway Mumbai central 400008 Phone no 67644544 & email- adrmnmctwr@gmail.com within 30 days.

Vijendra Kumar Meena
Public Information Officer
Sr. Divisional Engineer (N)
Office of Divisional Railway Manager,
Engg. Deptt. Mumbai Central.
Mumbai: 400008

C/ ACPIO & ACM (Advt) BCT



डेडीकेटेड फ्रेट कोरीडोर

डेडीकेटेड फ्रेट कोरीडोर कॉर्पोरेशन ऑफ इंडिया लि.
भारत सरकार (रेल मंत्रालय) का उपक्रम
Dedicated Freight Corridor Corporation of India Ltd.
A Govt. of India (Ministry of Railway) Enterprise

288

MUM/EN/N/CA-iii/367-V

Date : 12.04.2025

To,
GM/LA & SEMU
DFCCIL

Sub: - Reply to the representation of Shri. Manish Patel.
Ref: - CPGRAMS No. MORLY/E/2025/0007493

Sir,

With reference to the representation as received from Shri. Manish Patel R/o Mograwadi, Valsad, through CPGRAMS as reply is as enclosed herewith

12/04/2025
Shekhar Vasant Deshpande)
Project Manager/Engg
(North) Mumbai, DFCCIL

C/- CGM/N

Note

Sub:-Grievances of Shri Manish V Patel Mograwadi Near Railway station valsad Near Ramesh Guest House Mograwadi, -registration number : MORLY/E/2025/0007493

Ref:- Grievances of Shri Manish V Patel registration number : MORLY/E/2025/0007493 dated 07.03.2025

With reference to above, I, Executive/Engg/BL along with Jr.Executive Engg/BL have visited the house of Shri Manish V Patel Mograwadi Near Railway station valsad Near Ramesh Guest House Mograwadi. Following observations has been made in this regards:-

1. House has been inspected and following dimensions has been noted:-

| Sl No | Item | Distance |
|-------|--|----------|
| 1 | Distance of Boundary wall of house from DFC UP track | 10.9m |
| 2 | Distance of Edge of house from DFC UP track | 12.55m |
| 3 | Distance of Boundary wall of house from DFC/Railway boundary | 5.90 m |
| 4 | Distance of Edge of house from DFC/Railway boundary | 7.55 m |

The house is at distance of 12.55 m from DFC UP track and 7.55m from DFC/Railway boundary, hence safe.

- This house was inspected by DFC officials Executive Engg/BL and Jr.Executive Engg/BL and confirmed that no vibration observed at this house due to train movement and no such structural damage has occurred in this house due to train movement.
- In this location concrete Boundary wall has been constructed at Railway/DFC boundary by DFCCIL to ensure safety. As new house has not been constructed within 30m of railway boundary and the house exists before laying DFC track, NOC not required.
- Immediate safety inspection carried out by DFC officials i.e Executive Engg/BL and Jr.Executive Engg/BL.
- As the house is at a distance of 12.5m from DFC UP track and no damage has been occurred due to movement of train on DFC track, compensation of the house is not permitted on safety ground.
- As DFC has laid track on DFC/Railway land, no compensation is permitted.

The detailed remarks of the grievances of Shri Manish V Patel is tabulated below:-

Y.S.
Executive/BL
07/04/2025

| Sl No | Item | Reply |
|-------|---|--|
| 1 | I am filing this grievance regarding the critical safety hazard posed by the DFCCIL freight train track, which is only 3 meters away from my legally registered house. As per Railway Board guidelines, a minimum 30-meter distance is required between railway tracks and residential areas, yet this rule has been violated. No No-Objection Certificate (NOC) was issued, and no safety measures have been implemented. | <p>An inspection was carried out by Executive Engg/BL and Jr.Executive Engg/BL at this location and it was found that the house is a distance of 12.55 m from DFC UP line and 7.55 m distance from Railway Boundary. In the letter, the PAP has mentioned that the DFCCIL freight train is only 3 m away from his legally registered house is factually incorrect.</p> <p>As per Railway circular No.W419.L.NOC{GEN}III 28.05.2014 minimum clearance of 3.00m between Railway boundary and nearest edge of building shall be ensured. In this case the distance between Railway/DFC boundary and fencing of house is 5.9m and edge of house is 7.55m. In this location concrete Boundary wall has been constructed by DFCCIL at Railway/DFC boundary to ensure safety. As new house has not been constructed within 30m of railway boundary and the house exists before laying DFC track, NOC not required</p> |
| 2 | Due to continuous train movement and vibrations, my house and surrounding residential area have suffered severe structural damage, making it unsafe for habitation. Despite multiple complaints to DFCCIL officials and the local municipal corporation, no survey has been conducted, and no corrective action has been taken. Instead, authorities brought police forces to intimidate us, violating our rights and worsening our distress. | The house is at a distance of 12.55 m from DFC UP line and concrete boundary wall has been constructed at Railway boundary, hence no such vibrations observed during Train movement. This house was inspected by DFC officials Executive Engg/BL and Jr.Executive Engg/BL and confirmed that no vibration observed at this house due to train movement and no such structural damage has occurred in this house due to train movement. |
| 3 | <p>My Demands:</p> <p>Immediate safety inspection of the area to assess the risk to residents.</p> <p>Written clarification regarding the legality of residential proximity to the tracks.</p> | <p>Immediate safety inspection carried out by DFC officials i.e Executive Engg/BL and Jr.Executive Engg/BL.</p> <p>As the house is at a distance of 12.55m from DFC UP track and no damage has been occurred due to movement of train on DFC track, compensation of the house is</p> |

V. S.
 G. P. (Asstt. BL)
 07/04/2025

| | | |
|---|---|---|
| | Full compensation for my damaged house and residential area due to DFCCIL's project and train operations. | not permitted on Safety ground. As DFC has laid track on DFC/Railway land, no compensation is allowed. |
| 4 | Strict action against harassment faced by residents when raising concerns. | DFC Officials i.e Executive/Engg/BL and Jr.Executive/Engg /BL has visited the house of Shri Manish V Patel and talked to him regarding his complain. No harassment has been done to the resident and inhabitant of the house. |
| 5 | If this issue is not addressed within 30 days, I will escalate it to the Railway Ministry, NHRC, and the High Court for legal intervention. I urge you to take urgent action to prevent further damage and ensure our safety. | Noted. |

A sketch and photos showing exact distance between DFC track and house is enclosed here with at Annexure A for ready reference. Dy.PM/Engg/BL is requested to kindly take further necessary action forward the case.

[Signature]
Executive Engg/BL
07/04/2025

Dy.PM/Engg/BL

The detailed remarks of the grievances of Shri Manish V Rathod is tabulated as above after carrying inspection of the house by Executive Engg/BL on 07/04/2025. Dy.CPM/Engg/BL is requested to kindly take further necessary action

Dy.CPM/Engg/BL

[Signature]
Dy.CPM/Engg/BL
07/04/2025

Dy.CPM/Engg/BL *[Signature]*
07/4/25

APIO/MUM-N

Annexure A

Date of Inspection :- 07.04.2025

69

284

Sub:- Inspection of house of Shri Manish V Patel
Ref :- MORLY/E/2025/0007493 dated 07.03.2025

Plan of House

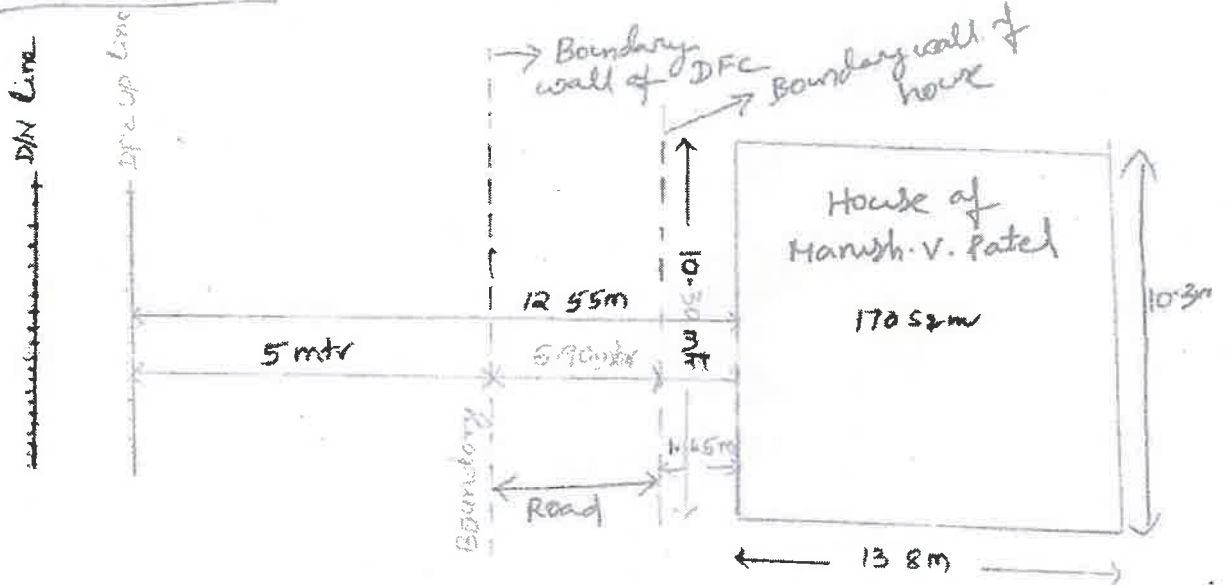

Elevation of House

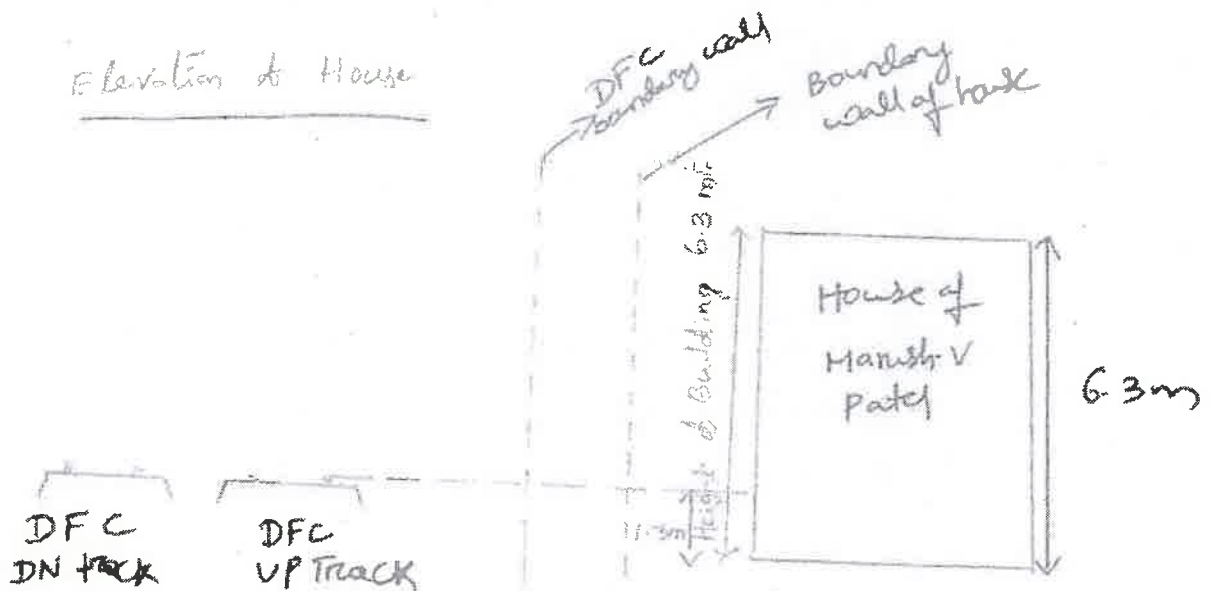

Height of building = 6.3m

Height of building from top of DFC UP line = 5m

Height from ground level = 6.3m = H

Clearance required = $H/2 = 3.15m$

Clearance from Railway boundary = 7.55m =

S. K. Rao
Sr. Civil Engg./B2
07.04.2025

V. S. Rao
Sr. Civil Engg./B2
07.04.2025