



डेडीकेटेड फ्रेट कोरीडोर

डेडीकेटेड फ्रेट कोरीडोर कॉर्पोरेशन ऑफ इण्डिया लि

भारत सरकार (रेल मंत्रालय का उपक्रम)

Dedicated Freight Corridor Corporation of India Ltd.

A Govt. of India (Ministry of Railways) Enterprises

No. ALD (E)/EN/RTI/71(Vol-III)/223

Date: 22.09.2023

JGM/Admin (PIO)

Corporate Office, DFCCIL
5th Floor Pragati Maidan
Metro Station Building Complex,
New Delhi.

Sub: Providing information w.r.t Original RTI Application received under the RTI Act 2005.
(RTI -797 & 840)

Ref: (i) RTI Ref. DFCCIL/R/E/23/00656 dt. 01.09.2023
(ii) RTI Ref. DFCCIL/R/E/23/00696 dt. 15.09.2023

With above reference, information sought by applicant Sh. Ajay Kumar Gupta 63/2C,
near Ghasiyari Mandi Chauraha, Canal Road, Kanpur is as below.

S No	Information sought	Information
1.	Please provide me the date on which request of inspection (RFI) of borrow area (B.A) No. 197 was received by DFCC from GMR.	Borrow area (B.A) No. 197 was sampled vide RFI on 28.04.2018 by PMC.
2.	Please provide me the date on which borrow area (B.A) No. 197 was approved by DFCC.	Borrow area (B.A) No. 197 was approved by PMC on 18.05.2018.
3.	Please provide the Chainage number where at material (SQ1) of borrowed area No. 197 was to be utilized.	The sub-grade material (SQ1) of Borrow area (B.A) No. 197 was utilized between New Karchana Station to New Yamuna Bridge.
4.	How much quantity of material (S.Q.1) of borrowed area No. 197 was approved?	Quantity approved by PMC.
5.	How much quantity of material (S.Q.1) of borrowed area No. 197 was utilized?	Approved quantity has been utilized by executing agency.
6.	Please provide location map of borrowed area No. 197 and details of approval of lead chart and certified documents related to the borrow area (B.A.) 197.	The location map and lead chart of approved borrowed area is enclosed here with as Annexure 1.

The above information has been obtained from PMC.

However, the required information is being sent for further action at your end.

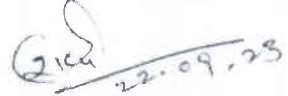
(Rajiv Kumar Srivastava)
APM/Co./PRYJ (E)

DA: As above.

Pt. No. 6

337

Name of the place: Village + Nibi Khurd
 District: ...
 State: ...
 Country: ...

LOCATION MAP OF BORROW AREA NO. 197 Village + Nibi Khurd

LOCATION & DIMENSION: 269+100 LHS leads. 2.5 k.m. Date of Sampling: 28-04-18

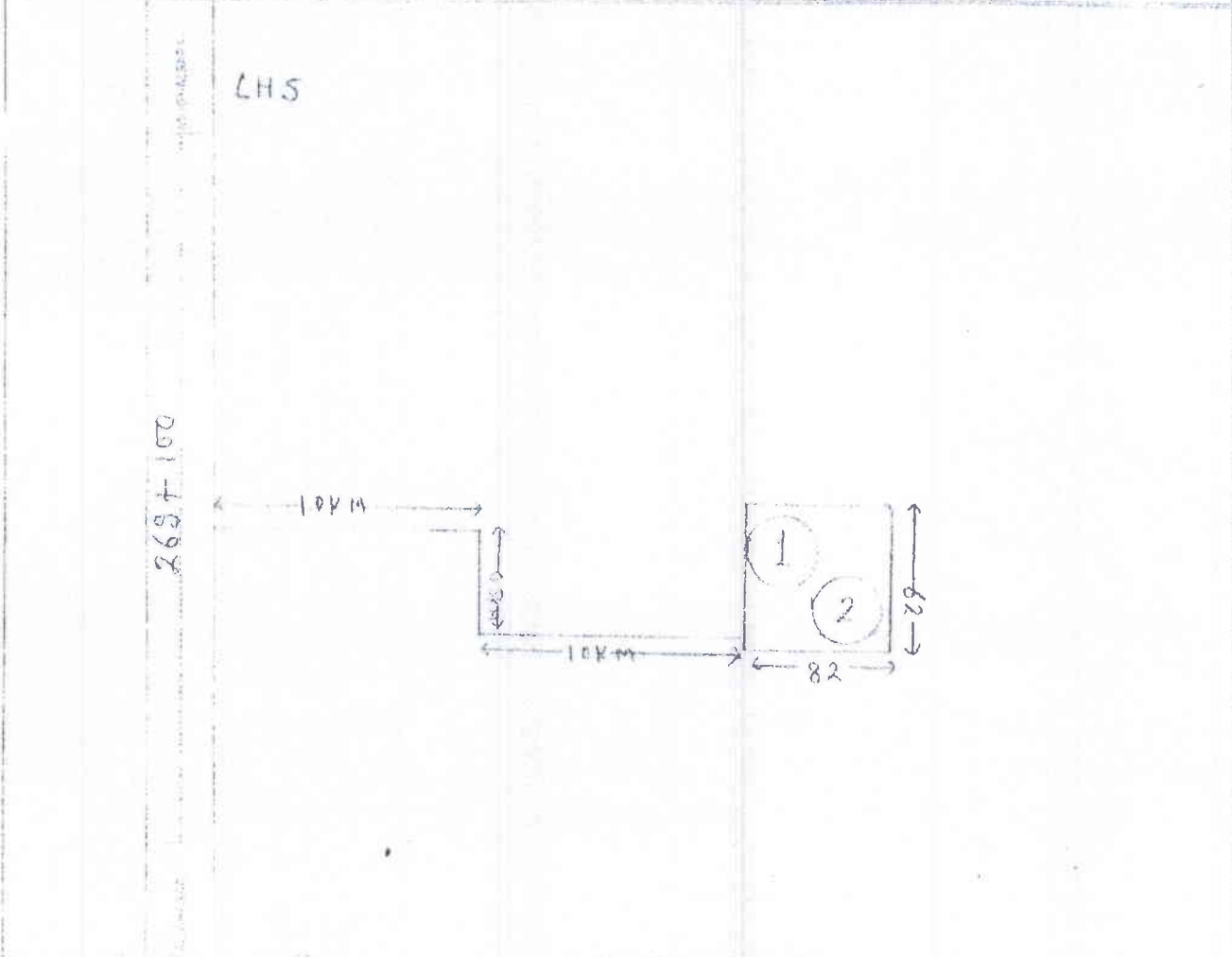

L X B X D = 82 X 62 X 2 = 10,168 M³ a)

Amit Kumar

(Gayeram)